

Type: Double Ended Beam

Material: Stainless Steel

Protection: IP 66

Application: Crane weighing systems
Where the load applied on a pin
Such as: crane overload control



Specifications:

Capacity	t	0.5 / 1 / 2 / 5 / 10 / 20 / 50 / 100 / 125
Max. Number of Verification Intervals		200
Temperature Effect on Zero	%FS/10°C	≤ ± 0.03
Temperature Effect on Sensitivity	%FS/10°C	≤ ± 0.03
Combined Error	%FS	≤ ± 0.5
Creep	%FS	≤ ± 0.1
Output Sensitivity	mv/v	1.0 ± 0.005
Input Resistance	Ω	750 ± 10
Output Resistance	Ω	702 ± 3
Insulation Resistance	MΩ	≥ 5000
Zero Balance	%FS	±1
Temperature, Compensated	°C	-10 ~ +60
Temperature, Operating	°C	-20 ~ +70
Excitation, Recommended	v	5 ~ 15
Safe Overload	%FS	150
Ultimate Overload	%FS	200
Standard Cable Length	m	10

Dimensions:

CAP.(t)	∅A	B	C	D	E	F	G	H	K
0.5	20	81	15	10	5	6	7	24	13
1.0	25	86	16	11	5.5	6	7.5	25	13.5
2.0	25	86	16	11	5.5	6	7.5	25	13.5
5.0	35	110	24	12	7.5	7	12	35	17.5
10	50	158	24	18	11	12	18	48	21
20	65	193	26	20	11	12	25	65	21
50	90	253	39	35	11	12	28	89	23
100	100	337	60	55	11	12	34	118	25
125	120	353	62	57	13	14	36	122	27

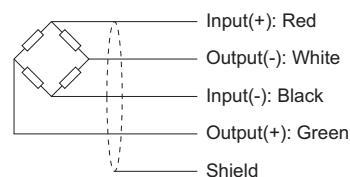
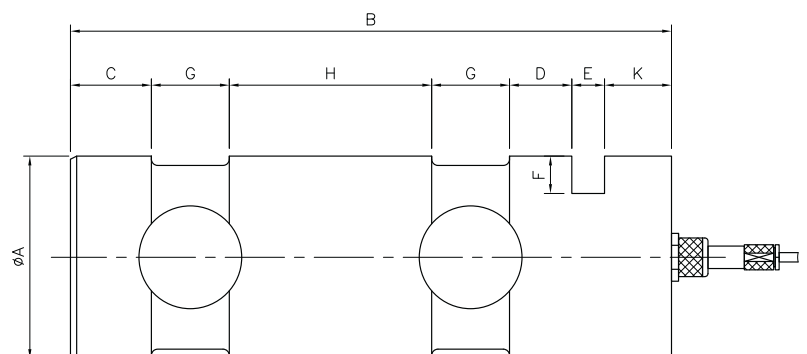

All dimensions: mm.